

LOC	DIST	REVISIONS					
		P	LTR	DESCRIPTION	DATE	DWN	APPD
HM	00	A		RELEASED: NS007-013	13MAR2007	GG	GB

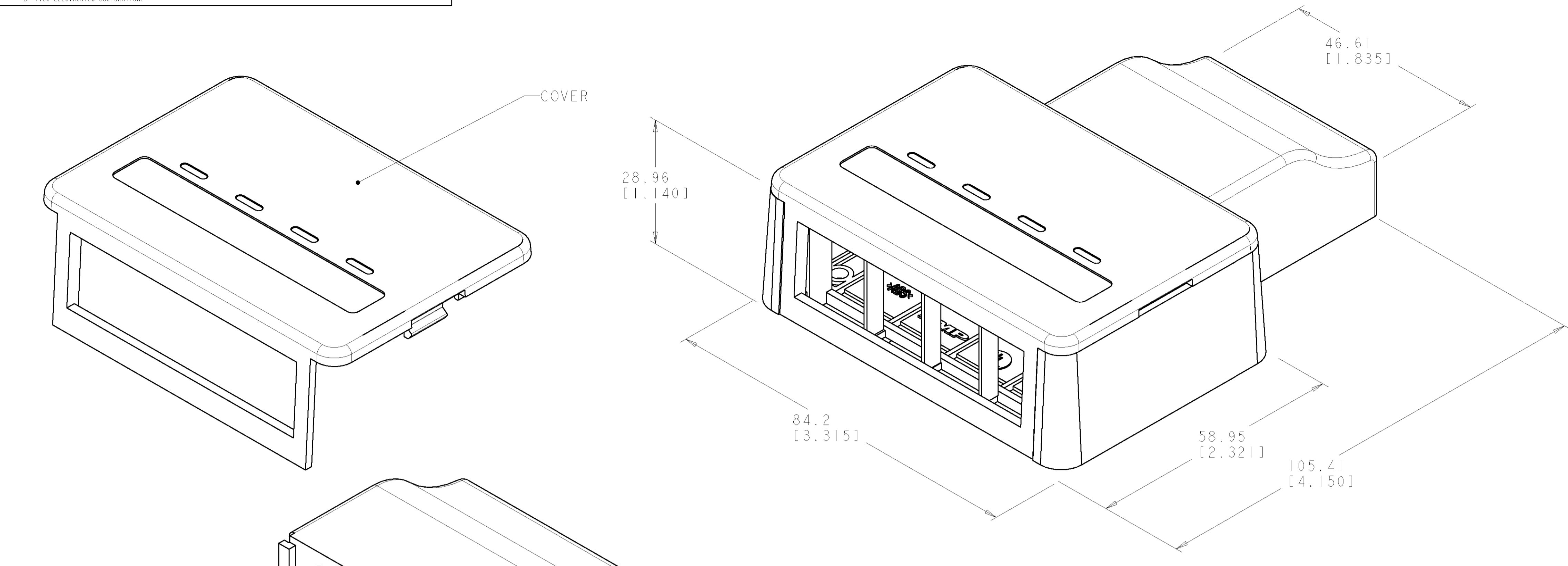

⚠ MATERIAL:
 BASE, COVER AND EXTENDER - ABS MOLDING COMPOUND. SEE TABLE FOR COLOR.
 FOAM TAPE - DOUBLE SIDED ADHESIVE. POLYETHYLENE.
 SCREWS - ZINC PLATED CARBON STEEL.

⚠ DIMENSIONS ARE NOMINAL UNLESS OTHERWISE SPECIFIED.

3. KIT SHIPPED NOT ASSEMBLED.

ASSEMBLED VIEW

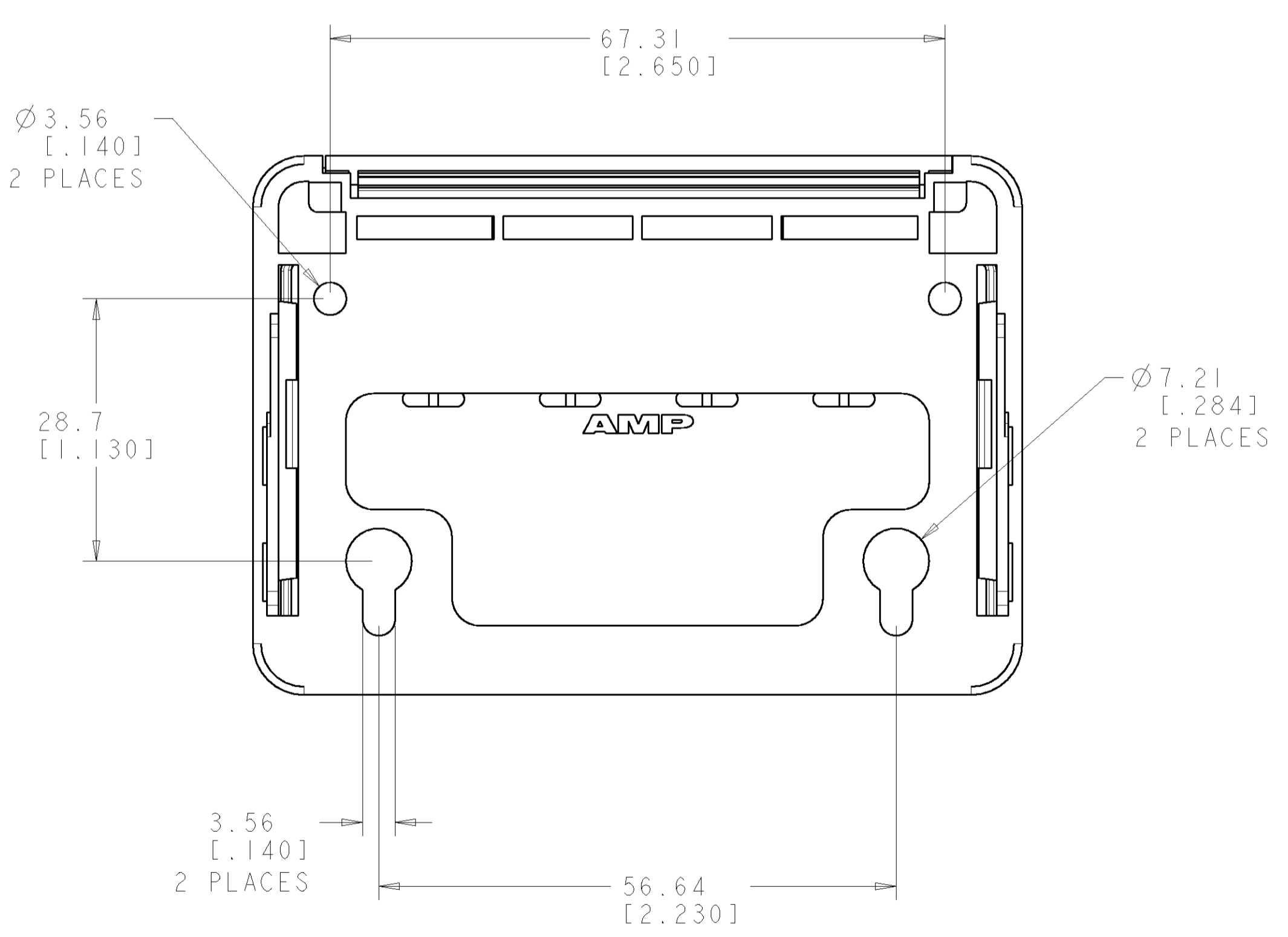
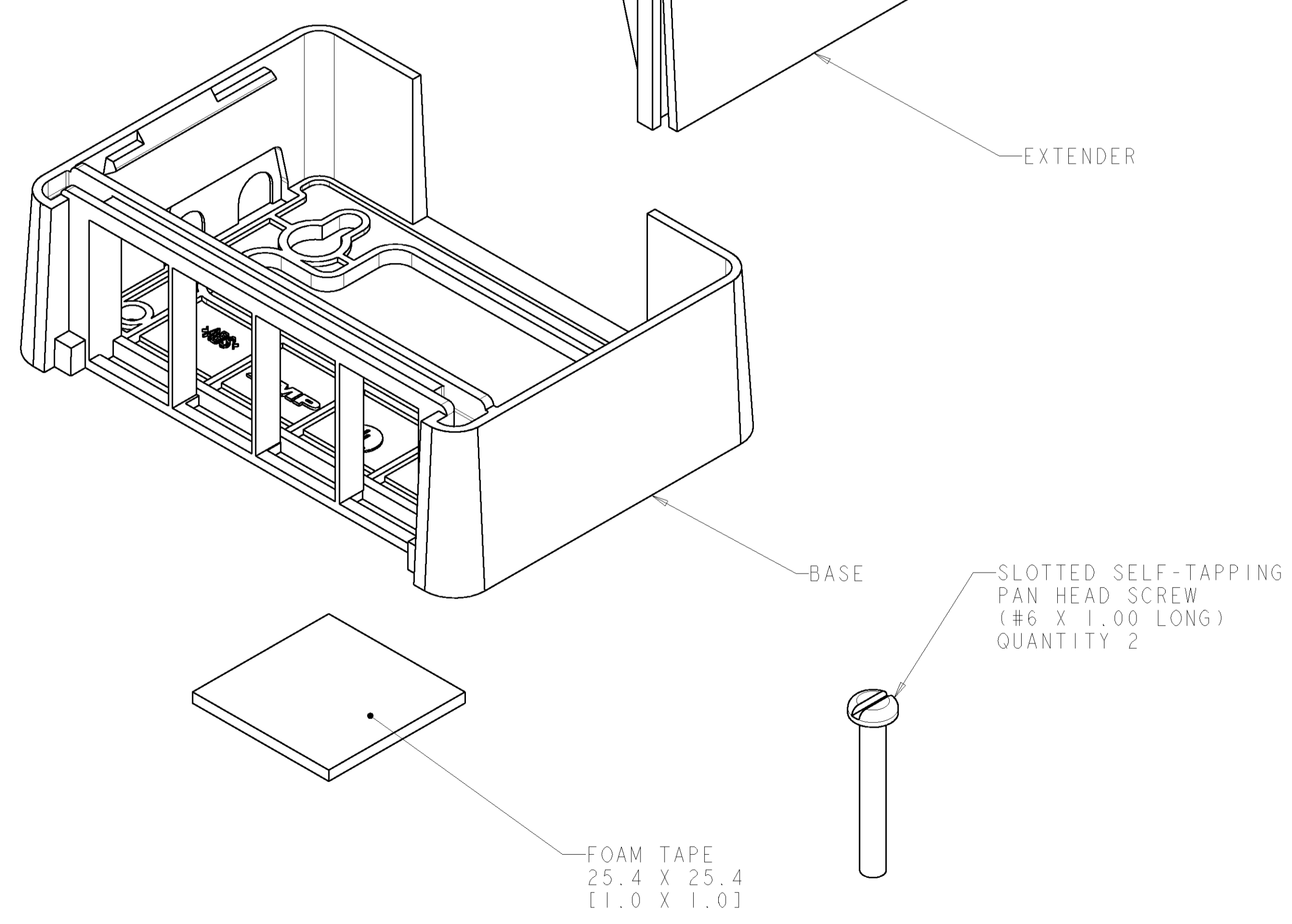

BOTTOM VIEW MOUNTING DIMENSIONS

COLOR	PART NUMBER
ELECTRIC IVORY	1-1933288-1
NEMA GRAY	1933288-4
WHITE	1933288-3
BLACK	1933288-2
LIGHT ALMOND	1933288-1

DIMENSIONS: mm [INCHES] TOLERANCES UNLESS OTHERWISE SPECIFIED: 0 PLC ± 1 PLC ± 2 PLC ± 3 PLC ± 4 PLC ± ANGLES ±		DWN: G. GARRETT 13MAR2007 ENR: G. BOWMAN 13MAR2007 APPD: G. BOWMAN 13MAR2007		Tyco Electronics Harrisburg, PA 17105-3608	
MATERIAL: \triangle FINISH: \triangle		PRODUCT SPEC: APPLICATION SPEC: WEIGHT: - CUSTOMER DRAWING		NAME: KIT, OFFICE BOX, EXTENDER, 4 PORT SIZE: A1 CAGE CODE: 00779 DRAWING NO: C=1933288 RESTRICTED TO: - SCALE: 2:1 SHEET 1 OF 1 REV A	